



CITY OF PALO ALTO OFFICE OF THE CITY CLERK

December 11, 2017

The Honorable City Council
Palo Alto, California

SECOND READING: Adoption of and Ordinance of the Council of the City Of Palo Alto Approving and Adopting Plans for the Highway 101 Bicycle and Pedestrian Bridge (FIRST READING: November 27, 2017 PASSED: 9-0)

This Ordinance was first heard by the City Council on Monday, November 27, 2017 and was passed 9-0. It is now before the Council for a second reading. The approved motion is below.

MOTION AS AMENDED RESTATED: Vice Mayor Kniss moved, seconded by Council Member DuBois to:

- A. Adopt the Resolution Adopting the Draft Mitigated Negative Declaration including the Mitigation Monitoring and Reporting Plan; and
- B. Approve the Record of Land Use Action approving the proposed Site and Design application based on the findings and subject to conditions of approval; and
- C. Adopt the proposed Park Improvement Ordinance (PIO) for the design of the Highway 101 Pedestrian/Bicycle Overpass Capital Improvement Project (CIP; PE- 11011); and
- D. Direct Staff to pursue other potential funding sources; and
- E. Direct Staff to explore sponsorship opportunities.

MOTION AS AMENDED PASSED: 9-0

ATTACHMENTS:

- Attachment A: Park Improvement Ordinance (PDF)

Department Head: Beth Minor, City Clerk

NOT YET APPROVED

ORDINANCE NO. _____

Ordinance of the Council of the City Of Palo Alto Approving and Adopting Plans for the Highway 101 Bicycle and Pedestrian Bridge

The Council of the City of Palo Alto does ORDAIN as follows:

SECTION 1. Findings. The City Council finds and declares that:

(a) Article VIII of the Charter of the City of Palo Alto and Section 22.08.005 of the Palo Alto Municipal Code require that, before any substantial building, construction, reconstruction or development is commenced or approved, upon or with respect to any land held by the City for park purposes, the Council shall first cause to be prepared and by ordinance approve and adopt a plan therefor.

(b) The Highway 101 Bicycle and Pedestrian Bridge Project is partially within the Baylands, which is dedicated parkland, as described in Municipal Code Section 22.08.020.

(c) The City intends to approve and adopt the plan to construct the Highway 101 Bicycle and Pedestrian Bridge, as detailed in Exhibit "A" and as generally listed below:

1. Construction of three new self-weathering steel trusses spanning Highway 101, and East and West Bayshore Roads, with safety railing.
2. Construction of cast-in-place concrete approach structures on east and west sides, with safety railing.
3. Construction of a new 140-foot long, self-weathering prefabricated steel truss over the Adobe and Barron Creeks confluence along West Bayshore Road.
4. Incorporation of a new pedestrian access ramp into the Western Approach Structure.
5. Construction of an overlook on the East Approach Structure.
6. Construction of three new trailheads/trail connections at West Bayshore Road, East Meadow Drive and East Bayshore Road.
7. Installation of pole, rail and handrail light-emitting diode (LED) lighting along the structure:
 - a) 15 Pole mounted lights containing 12-foot tall pole with field adjustable modules on the western approach structure.
 - b) Integrated rail lights throughout the pathway including 74 higher mounting height fixtures at the principal span and 141 lower mounting height fixtures at other locations.
 - c) 15 rail mounted step lights, ten in-ground step lights at the curb, and a linear LED light under the bench.
8. Removal and replacement of 28 trees with native trees in accordance with the City's Tree Technical Manual. Installation of vegetated swales.
9. Installation of enhanced amenities including bike racks and bike repair station, benches, trash receptacle, and drinking water fountains.
10. Incorporation of signage including wayfinding, informational and educational signs.
11. Asphalt concrete, compacted gravel, and fencing on Adobe Creek Reach Trail.
12. Street lights replacement, widened sidewalk and mid-block access to trailheads.

13. No lighting on the Adobe Creek Reach and Bay Trails.

SECTION 2. The Council hereby approves the Plan for construction of a new year-round, grade-separated, shared bicycle and pedestrian crossing over Highway 101 and Adobe Creek and hereby adopts the Plan attached hereto as Exhibit "A" as part of the official plan for the construction of Highway 101 Bicycle and Pedestrian Bridge.

SECTION 3. The City Council has reviewed and adopted a Mitigated Negative Declaration and a related Mitigation Monitoring and Reporting Program for this project by Resolution No. _____ on _____, 2017 prior to adoption of this ordinance. The Mitigated Negative Declaration concluded that the project would not have a significant effect on the environment with mitigation as proposed.

SECTION 4. This ordinance shall be effective on the thirty-first day after the date of its adoption.

INTRODUCED:

PASSED:

AYES:

NOES:

ABSENT:

ABSTENTIONS:

ATTEST:

City Clerk

Mayor

APPROVED AS TO FORM:

APPROVED:

Assistant City Attorney

City Manager

Director of Community Services

Director of Administrative Services

Exhibit A - Site Plan

SITE PLAN – ABOVE-GRADE FACILITIES

NOTES:

1. FOR GRADING DETAILS, SEE CONSTRUCTION DETAIL SHEETS.
2. FOR DRAINAGE IMPROVEMENTS, SEE CONSTRUCTION DETAIL SHEETS.
3. FOR BRIDGE DETAILS, SEE STRUCTURAL PLANS.
4. EXISTING EASEMENT RIGHTS ARE NOT ILLUSTRATED AS THESE RIGHTS AND BOUNDARIES ARE STILL BEING INVESTIGATED.

LEGEND:

- PCC SIDEWALK, PCC CR, AND PCC DRIVEWAY
- HMA OVERLAY (TYPE A)
- 1' HMA DEEP LIFT
- LANDSCAPE AREA
- DIRECTION OF FLOW

- CITY R/W
- CALTRANS R/W
- SCVWD R/W
- SAWCUT
- RETAINING WALL
- CUT AND FILL LINE

- EXISTING ROADSIDE SIGN
- PROPOSED ROADSIDE SIGN
- REMOVE EXISTING ROADSIDE SIGN
- EXISTING ROADSIDE SIGN TO REMAIN
- INSTALL NEW ROADSIDE SIGN

ABBREVIATIONS:

- C&G CURB & GUTTER
- CR CURB RAMP
- Rem REMOVE

1
C-1

DETAIL NUMBER DESIGNATION
DETAIL 1 ON SHEET C-1

UTILITY LEGEND:

- EXISTING WATER LINE
- EXISTING SEWER LINE
- EXISTING STORM DRAIN LINE
- EXISTING GAS LINE
- EXISTING RECLAIMED WATER LINE
- EXISTING OVERHEAD ELECTRICAL
- EXISTING CITY OF PALO ALTO & COMCAST JOINT OVERHEAD
- EXISTING UNDERGROUND JOINT TRENCH
- EXISTING UNDERGROUND TELECOMMUNICATIONS
- EXISTING UNDERGROUND ELECTRICAL
- EXISTING UNDERGROUND FIBER OPTIC
- EXISTING MANHOLE
- EXISTING UTILITY VALVE
- EXISTING UTILITY POLE
- PROPOSED UNDERGROUND FIBER OPTIC
- PROPOSED UNDERGROUND ELECTRIC
- PROPOSED WATER LINE

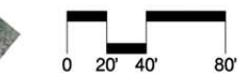
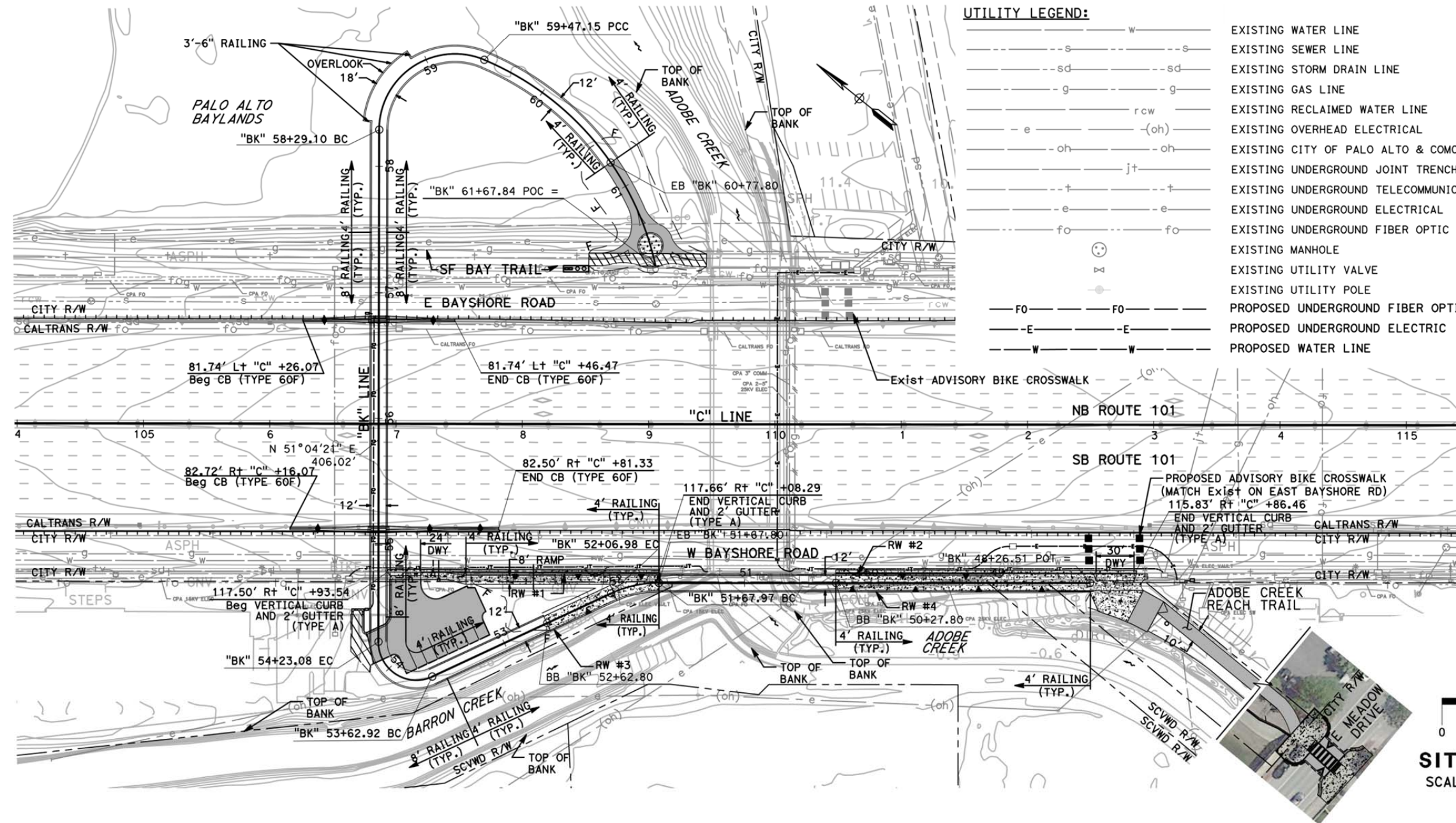

SITE PLAN
SCALE AS SHOWN

S-1